

CT-60

POINT OF SALE



FAST

- Multi-user cashier station with dual cash drawer support
- Built-in Mag-Stripe card reader
- High-resolution 10.1" color touch screen
- Built-in thermal receipt printer (2.25" paper width)
- Supports optional fee display and barcode reader



FLEXIBLE







- Numerous credit card solutions including: Mag-Stripe, P2PE EMV with or without pin pad, and NFC
- Rates can be fully programmed (password protected)
- Up to 18 pre-configured special buttons



CREDIBLE

- PCI 3.2 compliant
- FCC, CE, UL, CSA certified

About the New **TIBA X60 Series**.

-  Smarter and faster than ever with new product architecture.
-  Increased security to protect your data.
-  Connectivity using native TCP/IP and RS485.
-  User engagement through extra-large, high contrast touch screen.
-  Easy to install, service, and maintain.
-  Backward compatibility. Seamlessly mix X30 and X60 devices.
-  New technology. More features at a lower cost of ownership.

CT-60 POINT OF SALE

FEATURES

Driver Instruction Display	10.1" high-resolution color touch screen display
Credit Card Reader	Mag-Stripe, P2PE EMV with or without pin pad, NFC
Receipt Printer	Thermal printer; 2.25" paper width
Barcode Scanner	Reads multiple barcode formats - 1D & 2D, QR, and more. Supports various barcode credentials via mobile device or paper
Cashier Drawer	Up to two drawers
Validation Keys	18 dedicated programmable virtual validation keys; 99 additional validations supported
Customer Fee Display	Supported
Gate Control	Up to four lanes
Card Holder Access	Integrated with LPR and multiple card reader types

SOFTWARE FEATURES

Reporting	Multiple reports are accessible via FMS. POS supports various local reports, as Cashier shift and detailed receipt report
Pricelists	Advanced pricelist management
Cashiers	Cashier management for up to 128 cashiers with security access levels

OPERATIONS

Processor	Industrial controller with built-in operating system
Communication and Network	Native TCP/IP Ethernet, or RS-485 Communication
Built-In Clock	Lithium ion battery
Off-Line Operation	Off-line functionality supported
Remote Monitoring	Real-time transaction and events monitoring via Facility Management System

HOUSING

Construction	Stainless steel
Measurements	16.1" (41 cm) W; 14.2" (36 cm) D; 35.8 (91 cm) H
Weight	Dependent on components selected
Color (Housing)	Standard: White RAL 9010

ELECTRICAL

Voltage	100-240 VAC, 50-60 HZ
Current	1.35 approximate
Power Consumption	135W

ENVIRONMENTAL CONDITIONS

Operating Temperature	-4° to 122°F (-20° to 50°C) with heater
------------------------------	---

REGULATORY

Safety	UL 60950-1:2007 CAN/CSA-C22.2 No. 60950-1-07
EMC	CE, FCC Part 15, Subpart B, Class B

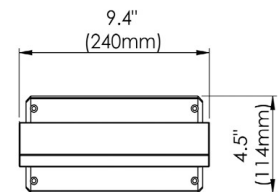
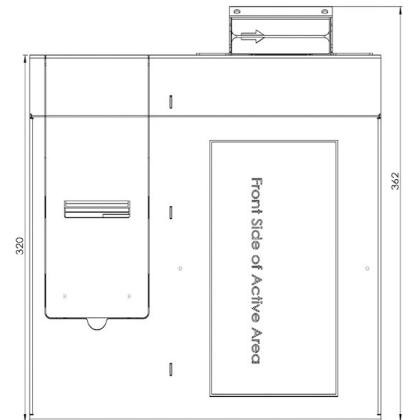
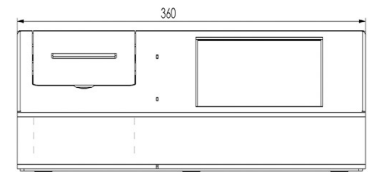

USA
2228 Citygate Drive
Columbus, Ohio 43219

T: +1 (614) 328-2040 F: +1 (614) 864-2153
866-901-8883 Toll Free

ISRAEL
17 Hamefalsim Street
Petah-Tikva, Israel 4951251

T: +972-3619-9777 F: +972-3-905-4306